



# IBA Pumps and Spare Parts

# IBA Teat Dip Mixing Pumps

IBA #	Description	Uses	In Depth
340890	CL02 Two Part Mixing Pump (HydroBlend)	2 part teat dips (Pro-San, Pre-Sept, Ect)	Air Driven Pump to mix 2 part teat dips. Simple to set up and use.
341255	Part A+B+H2O (HydroBlend)	CL02 Teat Dip Concentrates (Duet)	Water Driven pump that will mix 2 part teat dip concentrates <b><u>DOES NOT INCLUDE RTU TANK/FLOAT ASSEMBLY</u></b>
341260	Part A+B+H2O System Complete (HydroBlend)	CL02 Teat Dip Concentrates (Duet)	Water Driven pump that will mix 2 part teat dip concentrates <b><u>INCLUDES RTU TANK/FLOAT ASSEMBLY</u></b>
341220	Iodine Blending System (Dema)	Mixing Iodine Concentrates	Peristaltic pump system containing 3 pumps, One for water, one for iodine, one for emollient
341222	ASC Blending System (Dema)	2 part teat dips (Pro-San, Pre-Sept, Ect)	Peristaltic pump system containing 2 pumps
341205	One Shot 20 Oz T Dip Pump (Knight)	2 part teat dips (Pro-San, Pre-Sept, Ect)	Peristaltic pump system containing 2 pumps (T-50 pumps)
341207	One Shot 35 Oz T Dip Pump (Knight)	2 part teat dips (Pro-San, Pre-Sept, Ect)	Peristaltic pump system containing 2 pumps (T-66 pumps)
341230	2 Part Teat Dip Mix Pump (Knight Dairy Chem Plus)	CL02 Teat Dip Concentrates (Duet), 2-part teat dips (Pro-San, Pre-Sept ect.) Iodine concentrates	Contains 3 pumps, one for water, two for chemical. Meters in water and chemicals, more accurate than peristaltic systems.
341235	Knight OFB Connected Pump	CL02 Teat Dip Concentrates (Duet), 2-part teat dips (Pro-San, Pre-Sept ect.) Iodine concentrates	Contains 3 pumps, plus a water solenoid. Meters in water and chemicals for accuracy. Capable of mixing CL02 concentrates and emollients out of the box. Capable of making changes and monitoring remotely, as well as sending alarms to email.

HydroBlend



## HydroBlend

IBA #	Description	Use
340890	CL02 Two Part Mixing Pump	Two Part RTU Teat Dips (Pro-san, Pre-Sept, ect)
340891	V-Seal for 340890	Service parts for 340890
340895	Rebuild Kit for 340890	Service parts for 340890
341180	1/2 oz to 1 gallon fixed pump	Min Dilution 1:2500, Max Dilution 1:256
341182	47 oz fixed ratio pump	Min Dilution 1:30, Max Dilution 1:3
341255	Part A+B+H2O	Two Part Teat Dip Concentrates - <b><u>DOES NOT INCLUDE</u></b> RTU Tank setup
341260	Part A+B+H2O System Complete	Two Part Teat Dip Concentrates <b><u>INCLUDES</u></b> RTU Tank setup



## Repair Parts Page 1 for IBA# 341260

PART NO.	DESCRIPTION	QTY.	PART NO.	DESCRIPTION	QTY.	PART NO.	DESCRIPTION	QTY.
005-H2O FILTER	Sticker - Water Filter	1	229-1	Washer - .215 ID x .500 OD x .60 Thick - Plated	8	AIR-05	Adaptor, Straight - 1/4 MNPT x 3/8 Tube - Acetal	1
005-MAX PRESSURE	Sticker - Water Inlet - Maximum Inlet Pressure	2	230	Garden Hose Nut - Electroless Nickel Plated Brass	1	AIR-11	Gauge - 1/8 MNPT (Back Mount) - 0 - 200 PSI	1
005-MIX CHAMBER	Sticker - Mixing Chamber	1	251	Shelf - SST	1	AIR-14	Male Elbow w/ Buna O'Ring - 1/4 Tube x 1/4 MNPT - Acetal	1
???-SYSTEM STICKER	System Sticker	1	2561	Housing - Water Filter - (1/2 FNPT)	1	AIR-17	Flow Jet - G57 Air Pump - Viton Seals - 1/2 Port (Model # G573215D)	1
1036-R-064	See 1036-R For Size	1	256C	Water Filter Replacement Cartridge - 30 Micron	1	AIR-17B	Bracket - Flow Jet	1
1037-R-064	See 1037-R For Size	1	257K	Bumper Lock Nut	4	AIR-18	Straight - Flow Jet w/ Viton O'Ring - 1/2 Tube - Polypro	1
120V	O'ring - 7/8 ID x 1.0 OD x 1/16 CS - 75 Brn Viton	1	2606	Valve, Ball - 1/2 FNPT - 3 Way Panel Mount - Viton O'Ring - Polypropylene Reinforced with Fiberglass	2	AIR-19	Elbow - Flow Jet - 1/4 HB - Brass	1
153	Hose Washer - 3/4-GHT - Viton	1	262-500MNPT	Barb Fitting - 90 Degree - 1/2 MNPT x 1/2 HB - Polypro	1	AIR-19SE	Stem Elbow w/ Buna O'Ring - 1/4 Tube x 1/4 Stem - Acetal	1
203-500T	Check Valve - 1/2 MNPT - Viton Seal - Teflon Check Ball - Hastelloy Spring - Kynar Body	3	271-1	Nipple - 1/2 MNPT - 1-1/2 Long - SST	1	AIR-20	Straight - Flow Jet - 1/2 HB - Viton Seal - Polypro	1
211	Screw - 6-32 x 3/8 - Fillister SLTD - 18-8 SST	4	274-1	Tee - 1/2 FNPT x 1/2 FNPT x 1/2 FNPT - Sch 80 PVC	2	AIR-22	Regulator / Filter, Air Pressure - 1/4 FNPT - Adjustable - w/ automatic drain	1
219-500	Screw - #10 x 1/2 - Pan Head PLPS - 18-8 SST	4	275-1	Elbow - 1/2 FNPT - Threaded - Sch 80 PVC	3	AIR-23	Nut - Air Regulator - Mounting Nut - Metal	1
2191-1.000	Screw - #14 - Hex Washer Head SLTD - Plated	4	276-6	Nipple - 1/2 MNPT - 2.0 Long - Sch 80 PVC	2	AIR-25	Bracket - Air Regulator - Mounting Bracket	1
219-1.500	Screw - #10 x 1-1/2 - Pan Head PLPS - Plated	12	282-501	Water Pressure Regulator - 1/2 NPT - with Gauge - 15-80 PSI	1	Q11	Water Valve Foot	2
2191	Screw - #14 x 1/2 - Hex Washer Head SLTD - Plated	4	284-2	Adapter - 1/2 FNPT ID x 3/4 MNPT OD x 3/4 MGHT - 316 SST	1	Q23-1	Mur-lok Union Elbow w/ Viton O'Ring - 1/2 Tube x 1/2 Tube - Polypro	1
2192	Screw - #8 x 5/8 6 HD Oval SEMS Chrm	2	284-3	Adapter (Outlet) - 1/2 FNPT ID x 3/4 MNPT OD x 3/4 FGHT - 316 SST	1	Q23BK	Mur-lok Swivel Elbow w/ Viton O'Ring - 1/2 Tube x 1/2 MNPT - Polypro - Black Collet	1
2193	Screw - #12 x 1/2 - Pan Head PLPS - 18-8SST	4	4012-1.475	Inlet Fitting - 1/2 MNPT - SST	1	Q24-1	Mur-lok Swivel Elbow w/ Viton O'Ring - 1/2 Tube x 3/8 MNPT - Polypro	1
228-1	Washer - .281 ID x 5/8 OD x .038 Thick SST	4						

### Repair Parts Page 2 For IBA# 341260

PART NO.	DESCRIPTION	QTY.
Q27	Mur-lok Male Straight w/ Viton O'Ring - 1/2 Tube x 1/2 MNPT - Polypro	10
Q27BK	Mur-lok Male Straight w/ Viton O'Ring - 1/2 Tube x 1/2 MNPT - Polypro - Black Collet	1
Q28RD	Mur-lok Male Straight w/ Viton O'Ring - 3/8 Tube x 1/2 MNPT - Polypro - Red Collet	1
Q28YL	Mur-lok Male Straight w/ Viton O'Ring - 3/8 Tube x 1/2 MNPT - Polypro - Yellow Collet	1
Q29	Mur-lok Stem Elbow w/ Viton O'Ring - 1/2 Tube x 1/2 Stem - Polypro	8
Q29BL	Mur-lok Stem Elbow w/ Viton O'Ring - 1/4 Tube x 3/8 Stem - Polypro - Blue Collet	4
Q30	Mur-lok Union Elbow w/ Viton O'Ring - 1/2 Tube x 3/8 Tube - Polypro	1
Q31	Mur-lok Stem Straight - 3/8 Stem x 1/4 MNPT - Polypro	1
Q32BL	Mur-lok Union Tee w/ Viton O'Ring - 1/2 Tube - Polypro - Blue Collet	1
Q38	Mur-lok Tube Plug - 3/8	1
Q39	Mur-lok Tube Plug - 1/2	2

PART NO.	DESCRIPTION	QTY.
9572	Mixing Chamber & Jet Assy - 1/2 FNPT	1
9Q9	Float Assembly	1
9Q16	Tank Assembly - 064-System	1
9Q21	Water Valve Assembly	1
MV6120-Q24-DI-HDPE-E,VM	Hydro-Blend Proportioner	1
265A-10.500	Air Hose - 1/4 ID - 300PSI-Black	1
2691BK-36.000	Injection Tube - Black - 36"	1
2691BL-4.000	Injection Tube - Blue - 4.000"	1
2691BL-36.000	Injection Tube - Blue - 36"	1
269YL-36.000	Injection Tube - Yellow - 36"	1
2691WT-2.625	Injection Tube - White - 2.625"	1
2691WT-3.125	Injection Tube - White - 3.125"	1
2691WT-3.875	Injection Tube - White - 3.875"	1
2691WT-4.750	Injection Tube - 4.750"	1
2691WT-5.000	Injection Tube - White - 5.125"	1
2691WT-14.500	Injection Tube - White - 14.500"	1

IBA# 341255

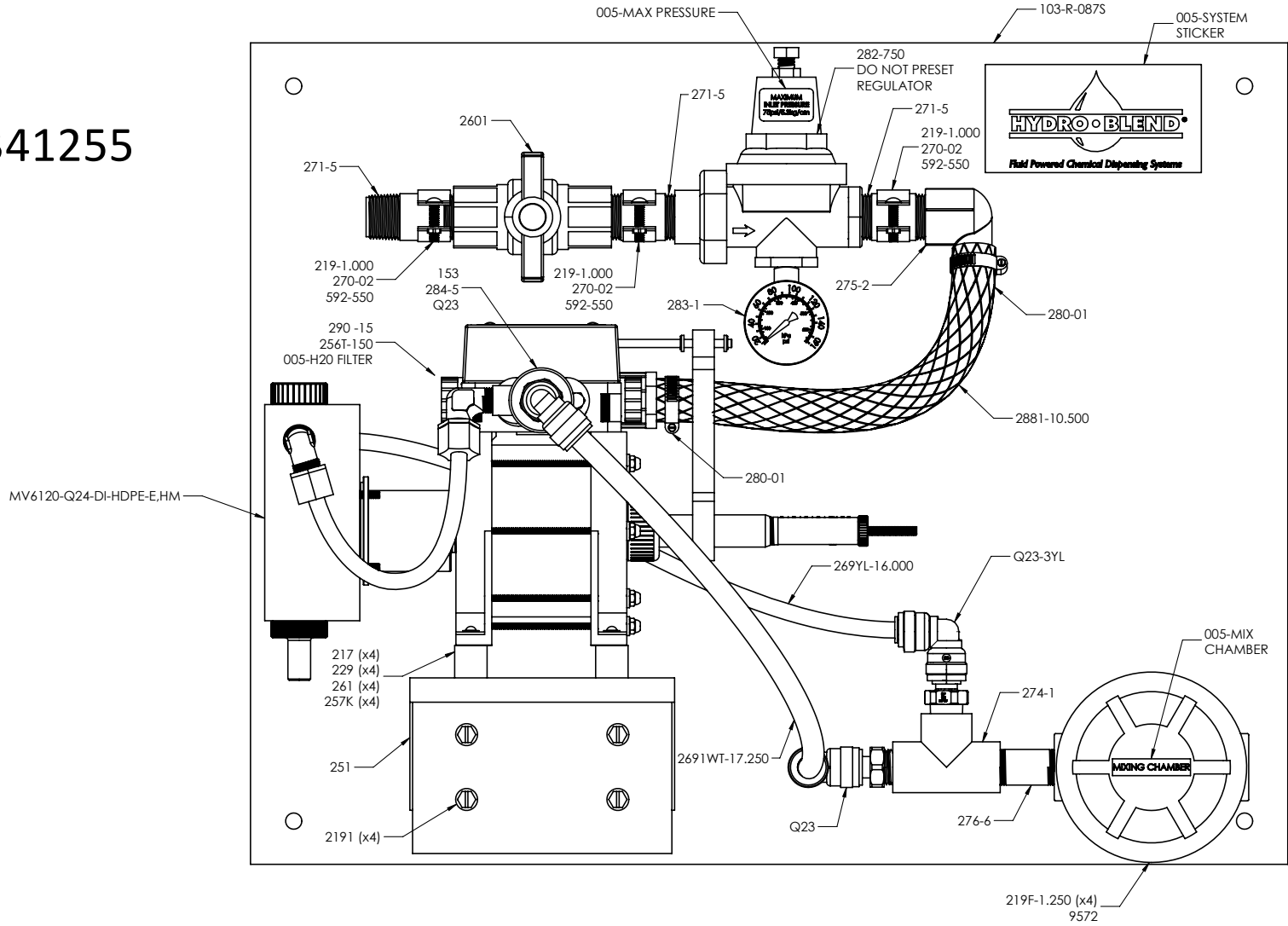

Repair parts  
for IBA#  
341255

PART NO.	DESCRIPTION	QTY.
005 - H2O Filter	Sticker - Water Filter	1
005-MAX PRESSURE	Sticker - Water Inlet - Maximum Inlet Pressure	1
005-MIX CHAMBER	Sticker - Mixing Chamber	1
005-SYSTEM STICKER	Sticker - System Sticker	1
103-R-087S	Backplate - 19.0 x 24.0 x 0.500 Thick - Polypro	1
153	Hose Washer - 3/4-GHT - Viton	1
217	Screw - 6-32 x 1-1/2 - Round Head SLTD - 18-8 SST	4
219-1.000	Screw - #10 x 1.0 - Hex Washer Head SLTD - Plated	3
2191	Screw - #14 x 1/2 - Hex Washer Head SLTD - Plated	4
219F-1.250	Screw - #10 x 1-1/4 - Flat Head PLPS - Plated	4
229	Washer - .174 ID x .375 OD x .031 Thick - SST	4
251	Shelf - SST	1
256T-150	Tee Housing & Filter Assy. - 3/4 FGHT x 3/4 MGHT - (150 Mesh/65 Micron Filter Cartridge)	1
257K	Bumper Lock Nut	4
2601	Valve, Ball - 3/4 FNPT - (EPDM O'ring) - Sch 80 PVC	1
261	Foot Rubber	4

PART NO.	DESCRIPTION	QTY.
2691WT-17.250	Injection Tube - White	1
269YL-16.000	Injection Tube - Yellow	1
270-02	Clamp, Pipe - 3/4 Dia. - Plated	3
271-5	Nipple - 3/4 MNPT - 2-1/2 Long - Sch 80 PVC	3
274-1	Tee - 1/2 FNPT x 1/2 FNPT x 1/2 FNPT - Sch 80 PVC	1
275-2	Barb Fitting - 90 Degree - 3/4 FNPT x 3/4 HB - Sch 80 PVC	1
276-6	Nipple - 1/2 MNPT - 2.0 Long - Sch 80 PVC	1
280-01	Clamp, Hose - SAE #10 - SST	2
282-750	Regulator, Water Pressure - 3/4 FNPT - 10-35 PSI	1
283-1	Gauge - 1/8 MNPT	1
284-5	Adapter (Outlet) - 1/2 FNPT x 3/4 FGHT - Kynar	1
2881-10.500	Nylon Reinforced Hose	1
290-15	Barb Fitting - Straight - 3/4 MNPT x 3/4 HB - Polypro - Black	1
592-550	Spacer - Acetal	3
MV6120-Q24-DI-HDPE-E,HM	Hydro-Blend Proportioner	1
9572	Mixing Chamber & Jet Assy - 1/2 FNPT	1
Q23	Mur-lok Swivel Elbow w/ Viton O'Ring - 1/2 Tube x 1/2 MNPT - Polypro	2
Q23-3YL	Mur-lok Swivel Elbow w/ Viton O'Ring - 3/8 Tube x 1/2 MNPT - Polypro	1

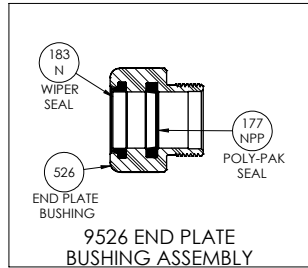

9526 END PLATE BUSHING ASSEMBLY  
DETAIL A  
SCALE 1:2

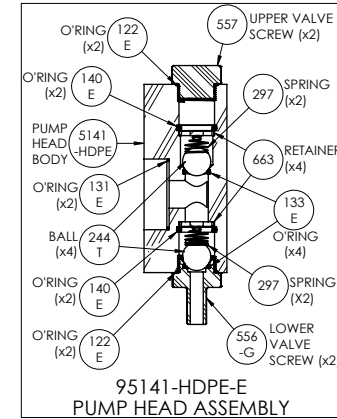
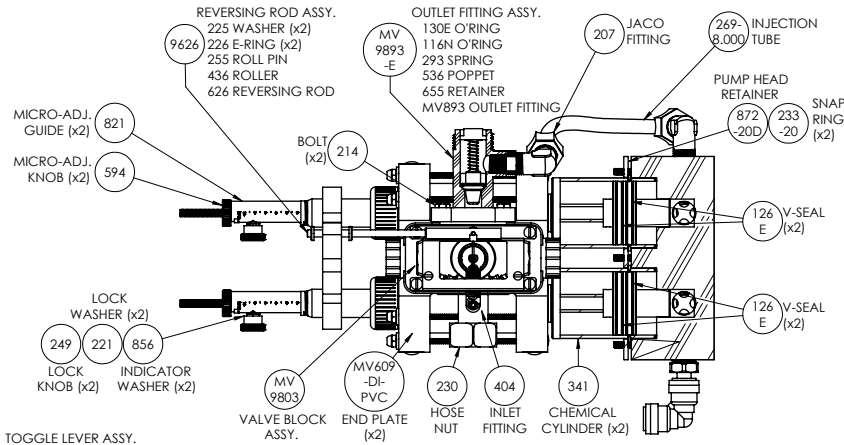

95141-HDPE-E  
PUMP HEAD ASSEMBLY  
DETAIL B  
SCALE 1:2

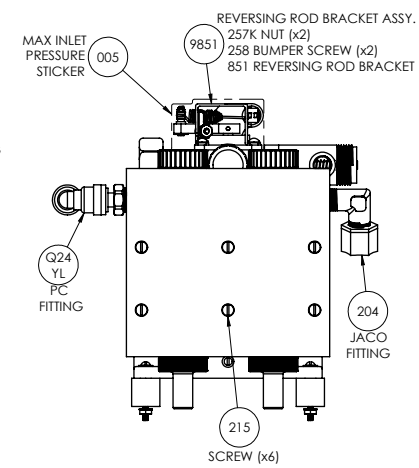
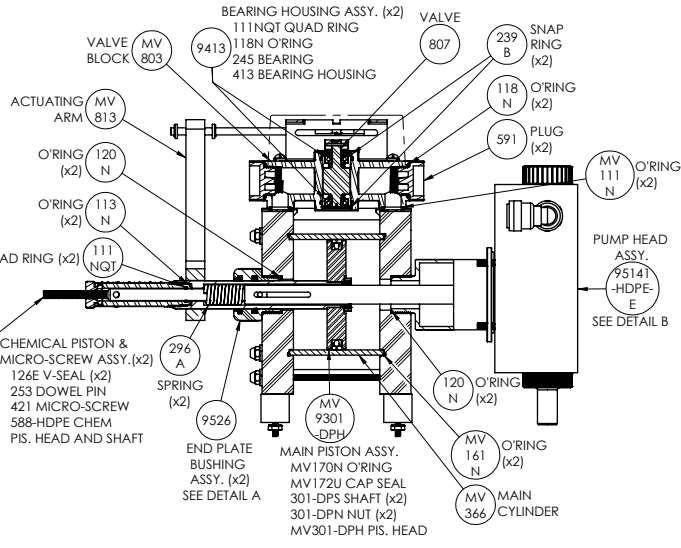
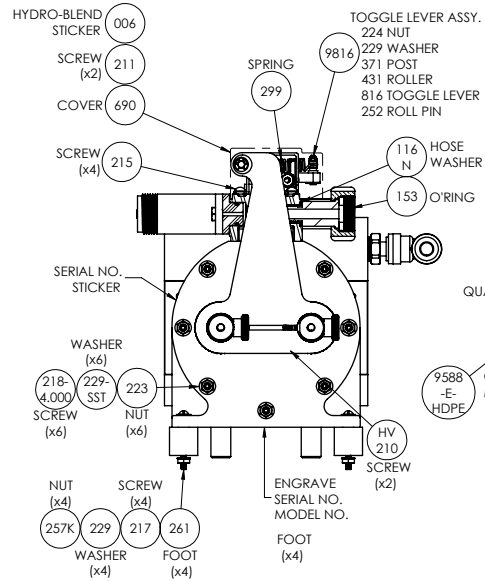

REVERSING ROD BRACKET ASSY.  
257K NUT (x2)  
258 BUMPER SCREW (x2)  
851 REVERSING ROD BRACKET

Knight



## Knight Pumps and Spare Parts (IBA Item Numbers)

IBA #	Description	In Depth
12509	PMP-8120B W/LT-300 C.B.	Single Knight T-66 pump with timer circuit board included
12512	PMP-5100 W/LT-300 C.B. 230 V	Single Knight T-50 pump with timer circuit board included
341205	ONE SHOT 20 OZ T DIP PUMP	Knight one shot w/ two T-50 pumps and start button for teat dip mixing (or other uses)
341207	ONE SHOT 35 OZ T DIP PUMP	Knight one shot w/ two T-66 pumps and start button for teat dip mixing (or other uses)
341230	Knight Dairy Chem Plus	Teat Dip mixing pump for concentrates
341231	RTU Tank with floats for Knight Mixing System	RTU Tank for Dairy Chem Plus
341235	Knight OFB Connected Pump	Teat Dip mixing pump for concentrates
595060	KNIGHT 1 PROD LIQUID DISP	Knight Single Product 1-shot (often used for laundry detergent)
595066	KNIGHT 2 PROD LIQUID DISP	Knight Dual Product 1-shot (often used for laundry detergent/fabric softener)
957820	CIRCUIT BOARD-KNIGHT 1SHOT	Knight One Shot Circuit Board Replacement
957828	PUMP BODY-KNIGHT 1 SHOT	Knight One Shot Pump Body (for T-50 pump)
957825	TRANSFORMER-KNIGHT 1 SHOT	Knight One Shot Spare Transformer
957832	FACE PLATE-KNIGHT 1 SHOT	Knight One Shot pump face plate (for T-50 Pump)
957830	ROLLER BLOCK-KNIGHT 1SHOT	Knight One Shot pump roller (for T-50 Pump)

# Knight OFB Mixing System Spare Parts

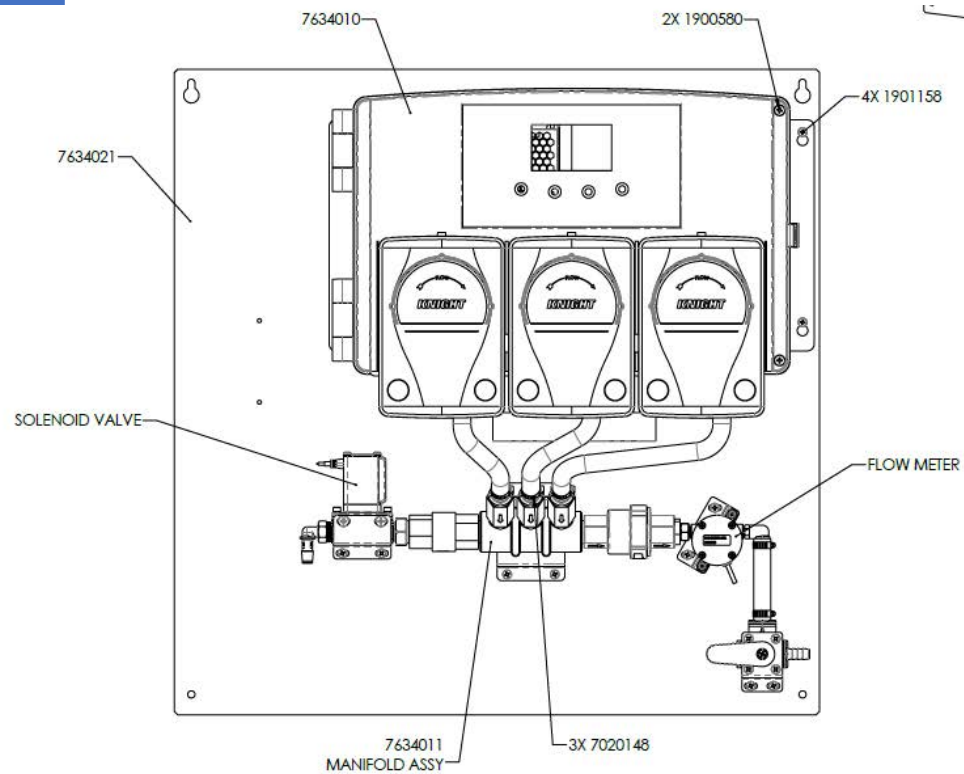

Knight OFB Spare Parts (Knight Part Numbers)

Part Number	Description
200129	Ball Valve, 3-Way, PP, EPDM, 3/8 Barb
6605203	Filter, 150 Micron, PP, .875 ID x 1.313 OD, .090 THK
7010116	Gear Motor, 110 RPM, 24 VDC, 800 series
7018066	Tube, T-66E, .350 ID .135 Wall
7633330	Roller Block, Yellow, T-50/T-66
7634011	ASSY, Manifold, OFB
7634012	Assy, In-Line Filter, FFKM' 1/2 FNPT
7634013	Kit, Secondary Mixer OFB
7634019	Tank Assy, OFB 7 Gallon
7634028	ASSY, Solenoid Valve, OFB Manifold
7634029	ASSY, Flow Meter OFB Manifold
7634034	Tank Assy, OFB 2.5 Gallon
7901245	Check Valve, Viton, Gray PVC, 3/8 Barb IN x 1/4 MNPT OUT
6536003-2	Pump faceplate
L521-0002	PCBA, Teat Dip

# Knight OFB Parts

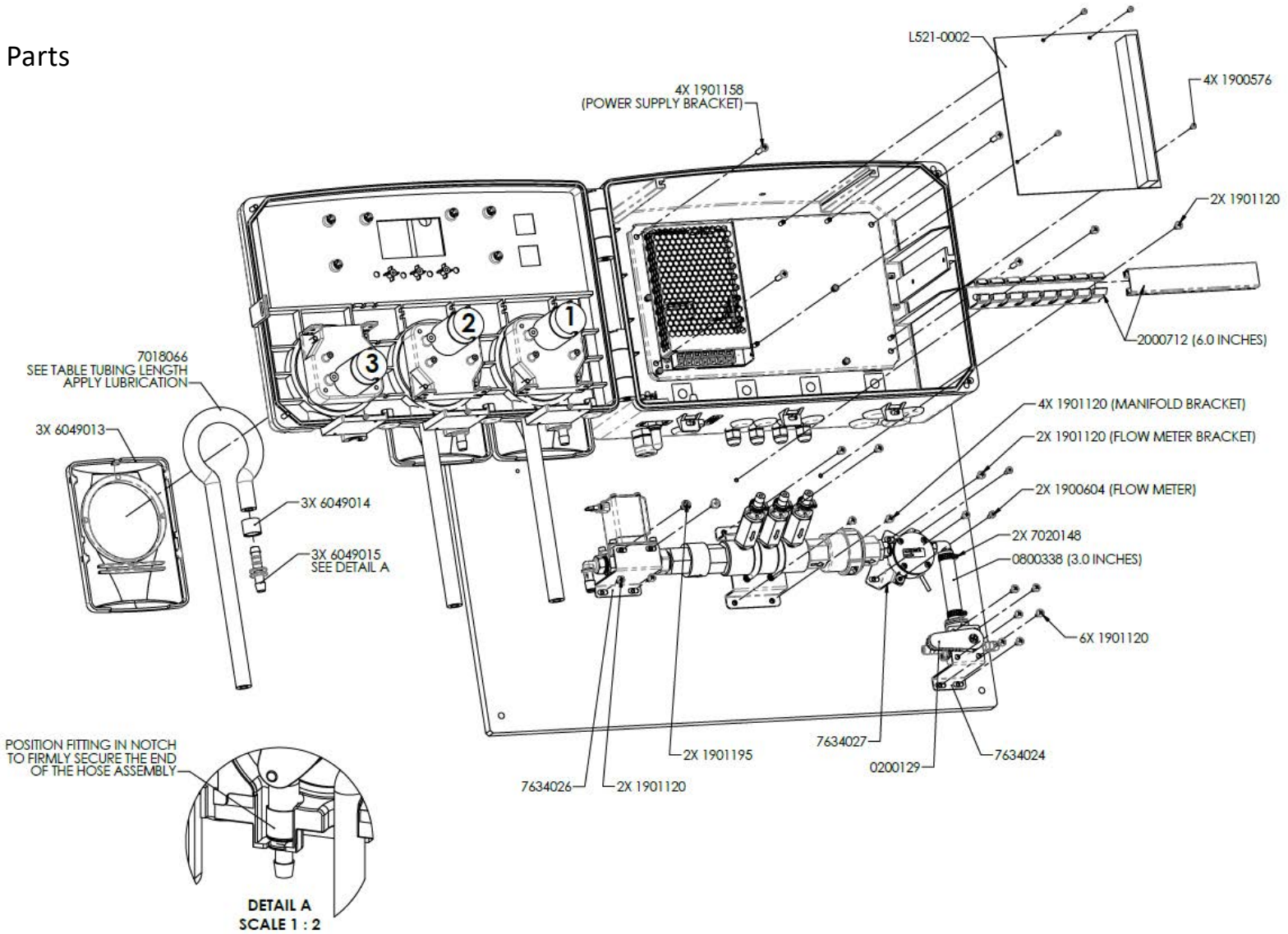

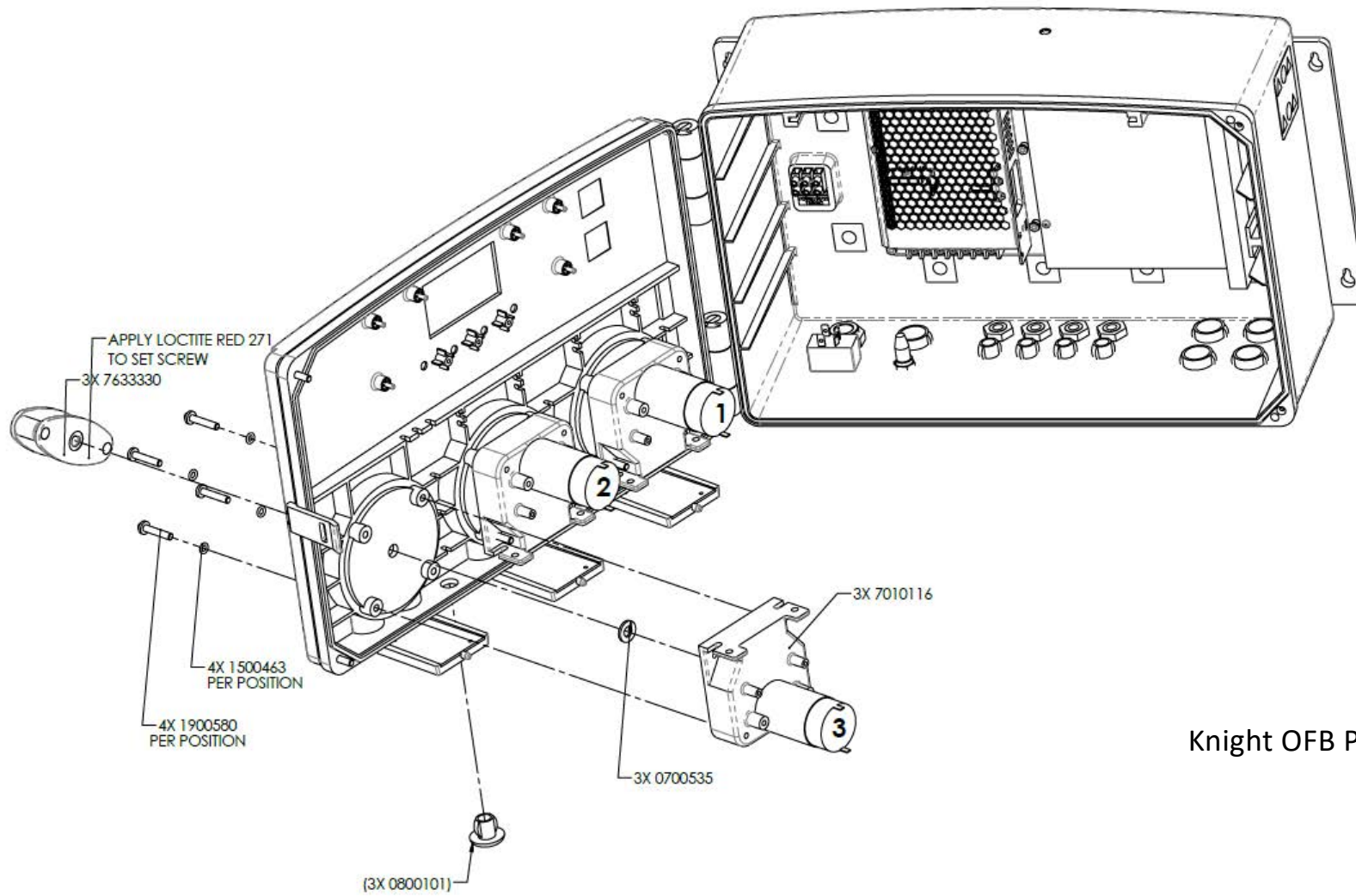

Knight OFB Parts

Knight OFB Parts

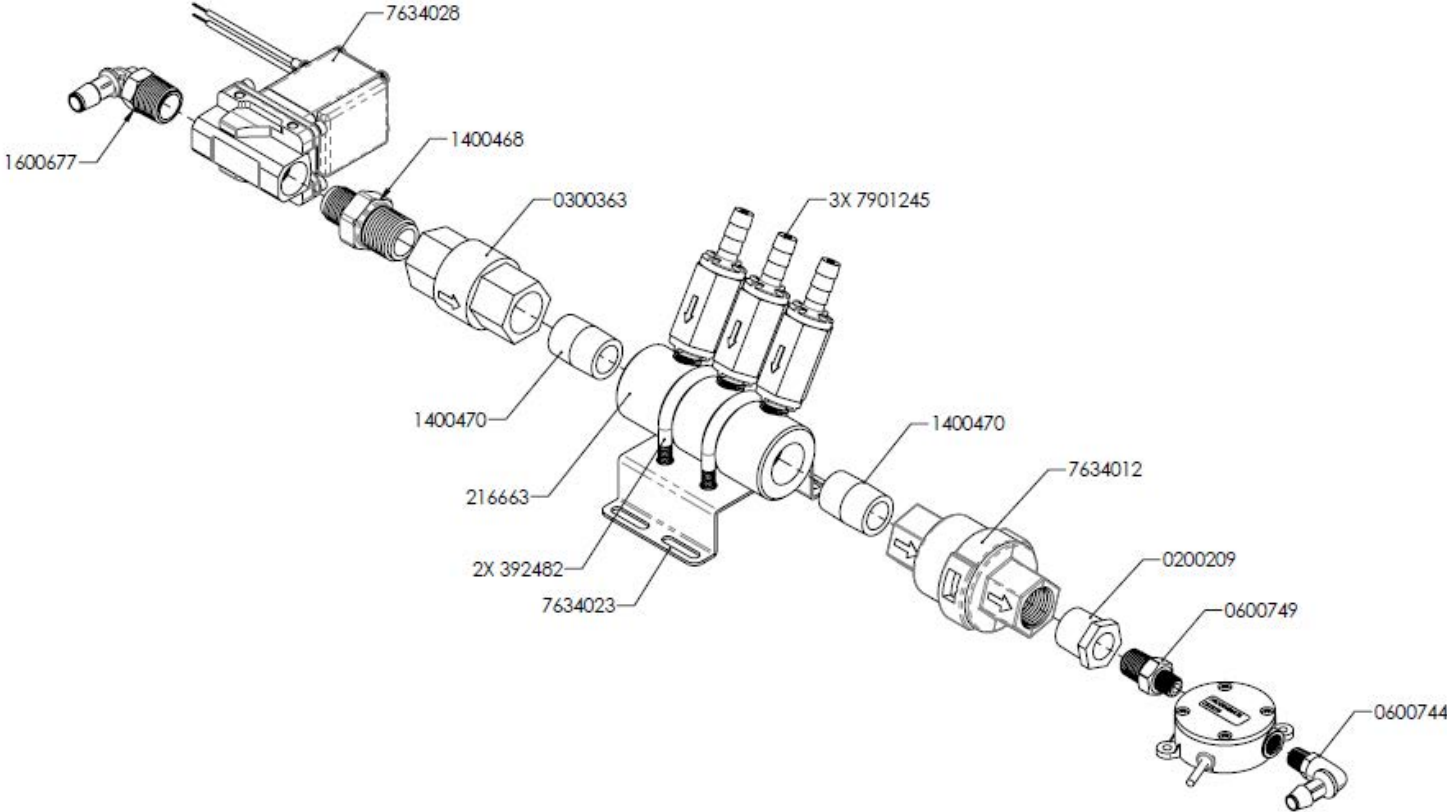

Knight OFB Parts

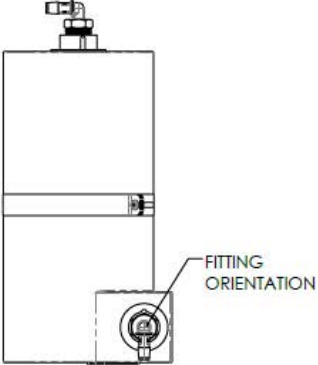
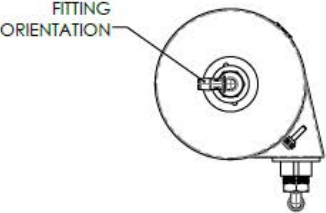
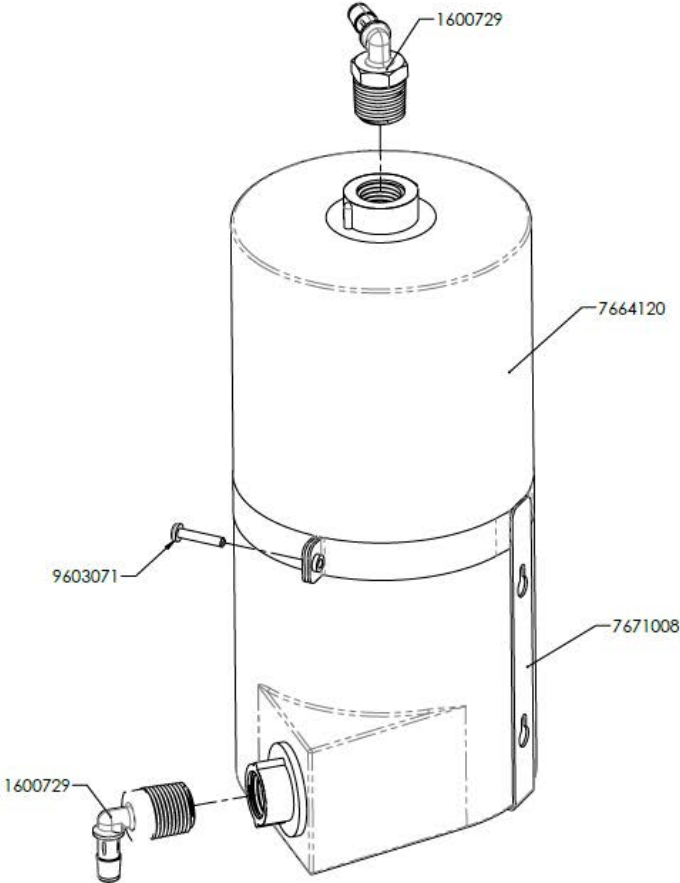

Knight Dairy  
Chem Plus  
Parts



# DAIRY-CHEM PLUS 3 PUMP SYSTEM WIRING DIAGRAM (7667090)

Knight Dairy Chem Plus  
Parts

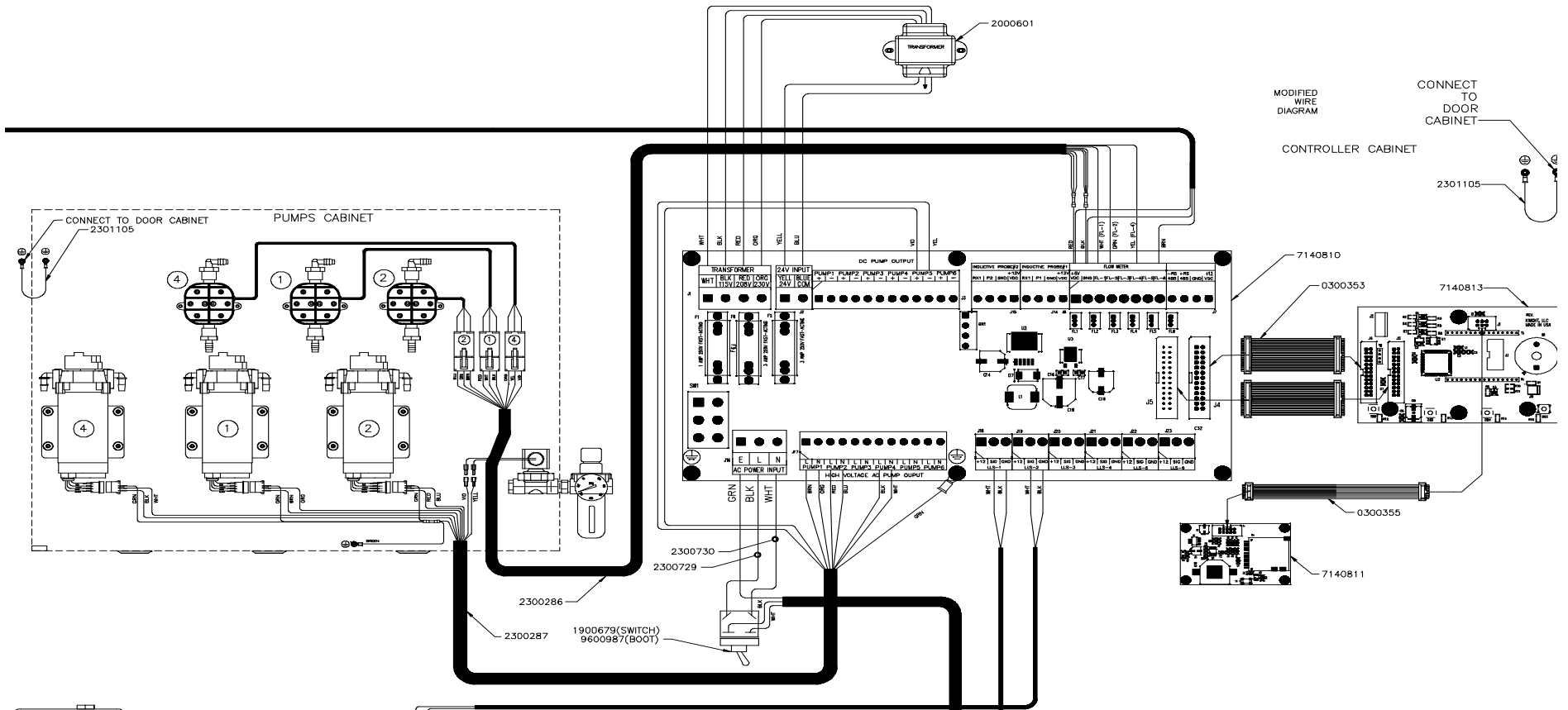

# Knight Dairy Chem Plus Parts

## IMPORTANT NOTE:

The pump for the water is larger than the chemical pumps- Be sure to order the correct pump!

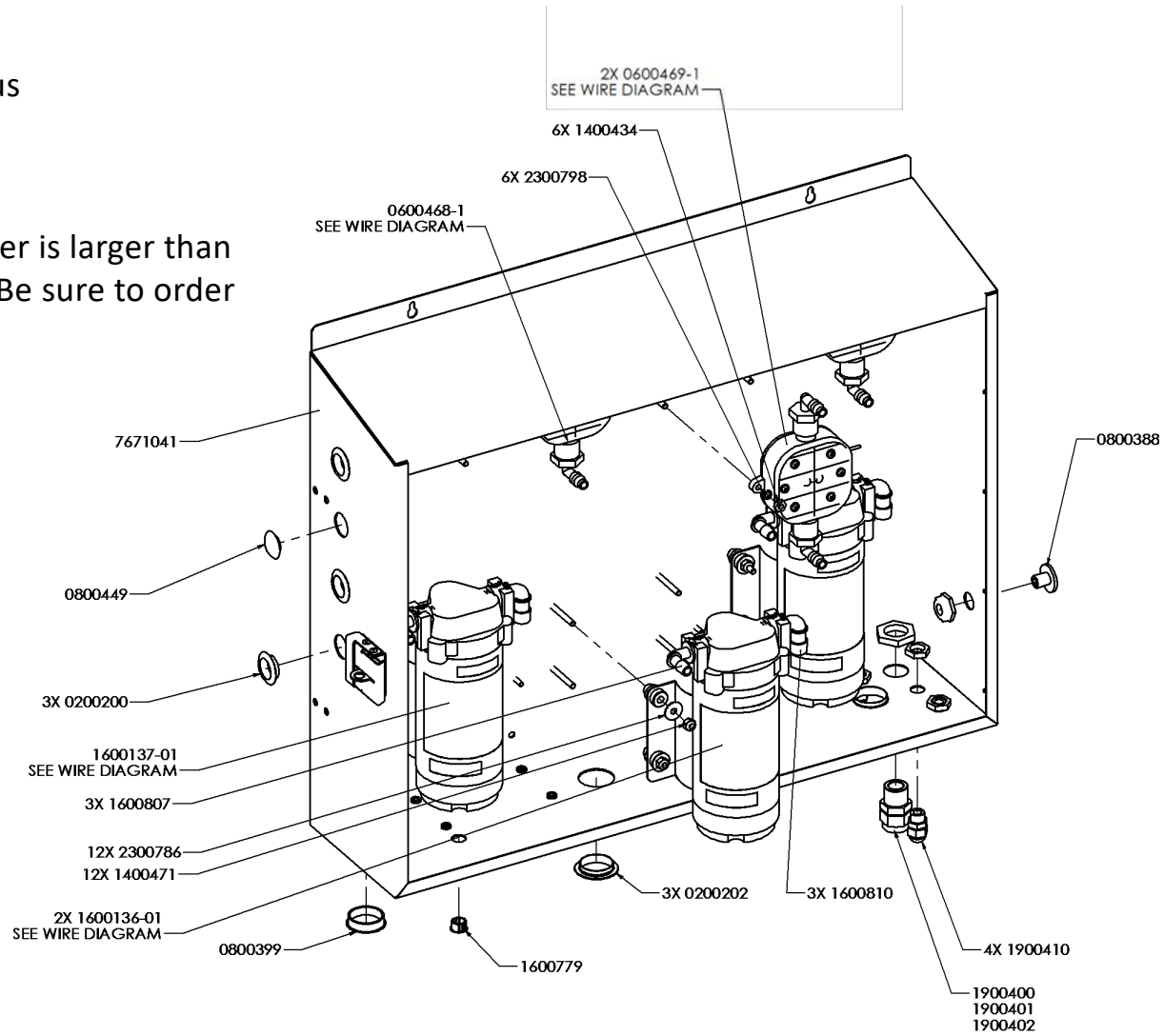

**PUMP CABINET ASSEMBLY**  
DOOR NOT SHOWN FOR CLARITY

3 Part (7667090) Exploded View Diagrams with PN's continued

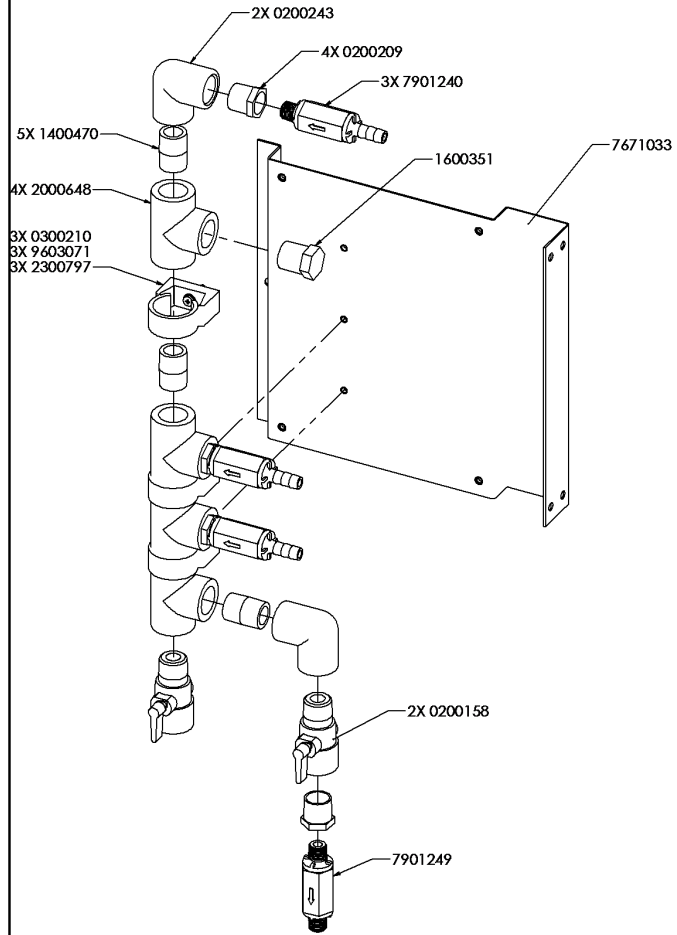

STATIC MIXER ASSEMBLY

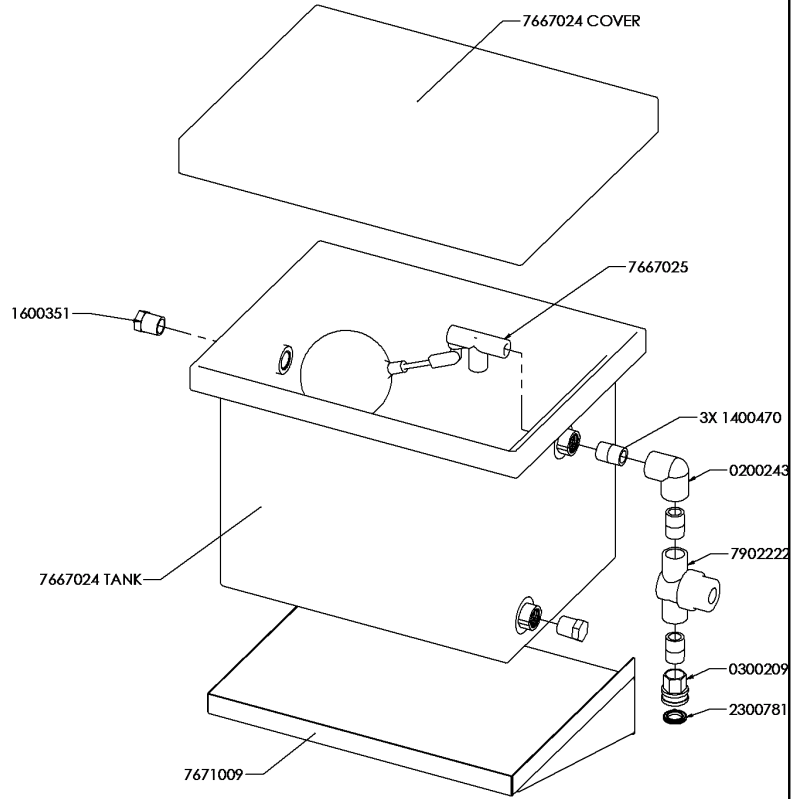

WATER TANK ASSEMBLY  
SCALE 1:6

# Knight Pumps T-66 Style Pump



## Identifying Characteristics

- 5 screws holding on cover
- 5/8 OD pump tubes
- Dual Pump Roller





# Knight Pumps T-50 Style Pump



## Identifying Characteristics

- 2 Screws holding on cover
- ½" OD pump tube
- Triple pump roller

# Knight Pump Tubes Identification

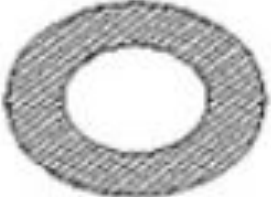
<b>TUBE</b>	<b>T-51</b>	<b>T-53</b>	<b>T-50</b>	<b>T-66</b>	<b>T-86</b>
<b>I.D.</b>	<b>1/8</b>	<b>3/16</b>	<b>1/4</b>	<b>3/8</b>	<b>1/2</b>
<b>O.D.</b>	<b>1/2</b>	<b>1/2</b>	<b>1/2</b>	<b>5/8</b>	<b>7/8</b>
<b>CROSS SECTION</b>					

# Knight Pump Tubes with IBA Codes







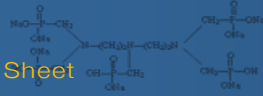

IBA #	PUMP	MATERIAL	LEGNTH	USES	DO NOT USE WITH
957796	T-50	Medsil	11"	Detergents, Alkaline, Chlorine, Mild Corrosives	Solvents/Oils
957802	T-50	EPDM	11"	Detergents, Chlorine, weak to medium acids	Oils
957803	T-50	Lexis	11"	Peracetic acid	Detergents
957804	T-50	Fluoro Viton	9"	Acids, Caustics, oils, solvents	
957805	T-50	Fluoro Viton	12.5"	Acids, Caustics, oils, solvents	
957798	T-66	Medsil	14"	Detergents, Alkaline, Chlorine, Mild Corrosives	Solvents/Oils
957810	T-66	Fluoro Viton	12.5"	Acids, Caustics, oils, solvents	
957800	T-66	EPDM	14"	Detergents, Chlorine, weak to meduim acids	Oils

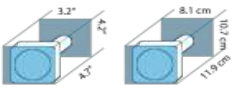
# Peristaltic PUMPS

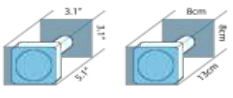
## Specification Sheet

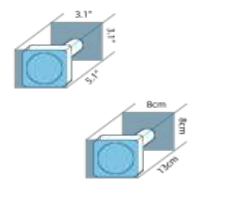

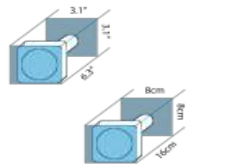
For liquid metering applications at low pressure a peristaltic pump is your best choice. Knight's range of variable (DC) and fixed speed (AC) pumps offers a wide range of flow rates and squeeze tubing for chemical and non-chemical applications. Choose the pump and squeeze tube from the tables below. Custom mounting brackets and special configurations are available upon request.

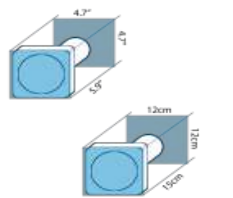



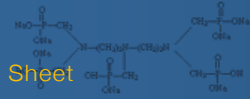

	Part Number	Flow Rate**		Tube Specify	Speed (RPM)	Max Back Press.		Electrical			Suction Lift		Weight		Duty Cycle***	Dimensions	
		(oz/min)	(ml/min)			(PSI)	(BAR)	Volt	Amps	AC/DC	(ft.)	(M)	(lb.)	(kg)			
 Hospitality Line	6326020	16.9	500	T-50EH	xx	40 PSI	2.8 BAR	24	2A	DC	10 ft.	3M	3.8 lb	1.4kg	continuous		
	6543020	.135 - 1.96	4 to 58	T-53EH	xx	40 PSI	2.8 BAR	24	2A	DC	10 ft.	3M	3.8 lb	1.4kg	continuous		
 UMP Digital	KP-515X	9800002-BK	.1 to 1.5	3 to 45	T-53	15	30 PSI	2 BAR	24	400mA	DC	10 ft.	3M	3.8 lb	1.4 kg	continuous	
  OP Pro / OP Elite	KP-5100DCX	8080151	10	300	T-50	100	30 PSI	2 BAR	24	400mA	DC	10 ft.	3M	3.8 lb	1.4 kg	continuous	
	KP-5200DCX	8080152	20	600	T-50	200	30 PSI	2 BAR	24	800mA	DC	10 ft.	3M	3.8 lb	1.4 kg	continuous	
  On-Premise Plus	KP-5100DCX	8155262	10	300	T-50	100	30 PSI	2 BAR	24	400mA	DC	10 ft.	3M	3.8 lb	1.4 kg	continuous	
	KP-5200DCX	8155362	20	600	T-50	200	30 PSI	2 BAR	24	800mA	DC	10 ft.	3M	3.8 lb	1.4 kg	continuous	
  KP-5100XP w/ quick change panel	KP-5100X	7108262-*	7.7	227	T-50	100	30 PSI	2 BAR	See Note*	1.5A	AC	10 ft.	3M	7.2 lb	2.7 kg	5min - ON 30min - OFF	
	KP-5100XP	8600120-*	7.7	227	T-50	100	30 PSI	2 BAR	See Note*	1.5A	AC	10 ft.	3M	7.2 lb	2.7 kg	5min - ON 30min - OFF	
		*Add (-01) to Part no. for 115V 60Hz															
		*Add (-02) to part no. for 230V 60Hz															
		*Add (-03) to part no. for 230V 50Hz															

\*\* Flow Rates are ± 10% Dependent on Application.  
 \*\*\* Duty Cycles— Maximum DC Motor life is 2000 hours.

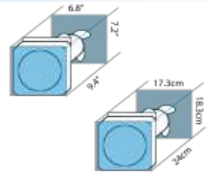
Peristaltic  
**PUMPS**  
Specification Sheet

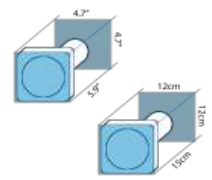

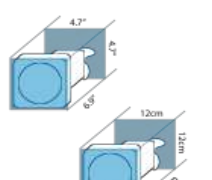
For liquid metering applications at low pressure a peristaltic pump is your best choice. Knight's range of variable (DC) and fixed speed (AC) pumps offers a wide range of flow rates and squeeze tubing for chemical and non-chemical applications. Choose the pump and squeeze tube from the tables below. Custom mounting brackets and special configurations are available upon request.

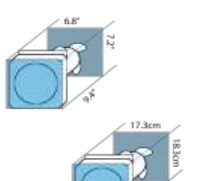
	Part Number	Flow Rate**		Tube Specify	Speed (RPM)	Max Back Press.		Volt	Electrical		Suction Lift		Weight		Duty Cycle***	Dimensions
		(oz/min)	(ml/min)			(PSI)	(BAR)		Amps	AC/DC	(ft.)	(M)	(lb.)	(kg)		
 KP-8110DCX OP Pro / OP Elite	8080109	36	1065	T-66	110	30 PSI	2 BAR	24	800mA	DC	10 ft.	3M	7.8 lb	2.9 kg	continuous	
 KP-8110DCX Chem-Trak Jr.	8155462	36	1065	T-66	110	30 PSI	2 BAR	24	800mA	DC	10 ft.	3M	7.8 lb	2.9 kg	continuous	
 KP-8120AX KP-8120AXP w/ quick change panel KP-8120BX KP-8120BXP w/ quick change panel	8507752-* 8600110-* 8507754-* 8600115-*	23 23 40 40	650 650 1184 1184	T-66	120	30 PSI	2 BAR	See Note*	1.5A	AC	10 ft.	3M	8.6 lb	3.2 kg	5min - ON 30min - OFF	
		*Add (-01) to Part no. for 115V 60Hz *Add (-02) to part no. for 230V 60Hz *Add (-03) to part no. for 230V 50Hz														
 KP-9130XP w/ quick change panel KP-9270XP w/ quick change panel	8600116-* 8600126-*	155 226	4588 6690	T-86	130	30 PSI	2 BAR	See Note*	3.0 A	AC	10 ft.	3M	11.5 lb	4.3 kg	5min - ON 30min - OFF	
		*Add (-01) to Part no. for 115V 60Hz *Add (-02) to part no. for 230V 60Hz *Add (-03) to part no. for 230V 50Hz														

\*\* Flow Rates are ± 10% Dependent on Application.  
 \*\*\* Duty Cycles— Maximum DC Motor life is 2000 hours.

Peristaltic Squeeze  
**TUBES**  
Specification Sheet

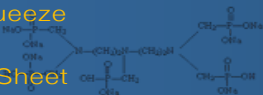

Squeeze Tubes are available in a wide variety of rubber and synthetic materials. Select the appropriate material that matches the flow rate of the pump and chemical to be pumped.

The chart below should be used as a reference tool only. Actual tube compatibility with chemical blends subject to environmental and "in situation" variables including:  
1.head pressure 2.temperature 3.viscosity 4.chemical concentration

	Model Number	Part Number	Dimensions (inch) ID X Wall x OD (ref)	Dimensions (mm) ID X Wall x OD (ref)	Length (inch)	Length (mm)	Roller Block	Description*
<p><b>BV</b> LEXSIS</p>	T-50-BV	7018047	.25 x .13 x .52	6.4 x 3.4 x 13.2	BULK	BULK	RB-550, RB-850	The new BV tube is made of a new high grade Lexsis compound that is specifically designed to last with Peracetic Acid, Iron Sours, Sours, Neutralizers, Chlorine, and other Acids.
	T-50-BV	7018047-11	.25 x .13 x .52	6.4 x 3.4 x 13.2	11"	279.4 mm	RB-550, RB-850	
	T-50-BV	7018047-14	.25 x .13 x .52	6.4 x 3.4 x 13.2	14"	355.6 mm	RB-550, RB-850	
	T-66-BV	7018048	.35 x .13 x .62	8.9 x 3.4 x 15.7	BULK	BULK	RB-550, RB-850	
	T-66-BV	7018048-14	.35 x .13 x .62	8.9 x 3.4 x 15.7	14"	355.6 mm	RB-550, RB-850	
<p><b>D</b> DURO</p>	T-50-D	7018055	.25 x .13 x .52	6.4 x 3.4 x 13.2	BULK	BULK	RB-550, RB-850	A resilient neoprene tube that is compatible with Alkalis, Builders, Breaks, Surfactants, and Detergent compounds.
	T-50-D	7018045	.25 x .13 x .52	6.4 x 3.4 x 13.2	11"	279.4 mm	RB-550	
	T-50-D	7018046	.25 x .13 x .52	6.4 x 3.4 x 13.2	14"	355.6 mm	RB-550	
<p><b>E</b> EPDM</p>	T-50E	7018050	.25 x .13 x .52	6.4 x 3.4 x 13.2	BULK	BULK	RB-550, RB-850	The EPDM tube is resilient with excellent memory and field proven mechanical reliability. Compatible with weak to strong corrosive solutions including: Alkalis, Builders, Breaks, Surfactants, Detergent compounds, Chlorine, Iron Sours, weak to medium Acids, and Rinse Agents.
	T-50E	7018051	.25 x .13 x .52	6.4 x 3.4 x 13.2	11"	279.4 mm	RB-550, RB-850	
	T-50E	7019060	.25 x .13 x .52	6.4 x 3.4 x 13.2	14"	355.6 mm	RB-550, RB-850	
	T-51E	7018021	.11 x .20 x .52	2.4 x .13 x 13.2	BULK	BULK	RB-551	
	T-51E	7018020	.11 x .20 x .52	2.9 x 5.2 x 13.2	11"	279.4 mm	RB-551	
	T-53E	7018056	.19 x .16 x .51	4.7 x 4.1 x 13.0	BULK	BULK	RB-553	
	T-53E	7018063	.19 x .16 x .51	4.7 x 4.1 x 13.0	11"	279.4 mm	RB-553	
	T-66E	7018066	.35 x .13 x .62	8.9 x 3.4 x 15.7	BULK	BULK	RB-550, RB-850	
	T-66E	7018068	.35 x .13 x .62	8.9 x 3.4 x 15.7	14"	355.6 mm	RB-550, RB-850	
	T-86E	7028662	.48 x .19 x .86	12.2 x 4.8 x 21.8	20"	508.0 mm	RB-986	
<p><b>EP Plus</b> EPDM PLUS</p>	T-50EP Plus	7018031	.25 x .13 x .52	6.4 x 3.4 x 13.2	BULK	BULK	RB-550, RB-850	EP Plus is an enhanced EPDM tube that is designed to last longer with Alkalis, Builders, Breaks, Surfactants, Detergent compounds, Chlorine, Iron Sours, weak to medium Acids, and Rinse Agents.
	T-50EP Plus	7018031-11	.25 x .13 x .52	6.4 x 3.4 x 13.2	11"	279.4 mm	RB-550, RB-850	
	T-66EP Plus	7018042	.35 x .13 x .62	8.9 x 3.4 x 15.7	BULK	BULK	RB-550, RB-850	
	T-66EP Plus	7018042-14	.35 x .13 x .62	8.9 x 3.4 x 15.7	14"	355.6 mm	RB-550, RB-850	
<p><b>EH</b> EPDM PLUS</p> <p>Hospitality Line</p>	T-50EH Plus	7018061	.25 x .06 x .38	6.5 x 1.5 x 9.7	BULK	BULK	6326023	EH tube is made with the new EPDM Plus material that is designed to last longer with Alkalis, Builders, Breaks, Surfactants, Detergent compounds, Chlorine, Iron Sours, weak to medium Acids, and Rinse Agents.
	T-50EH Plus	6326019	.25 x .06 x .38	6.5 x 1.5 x 9.7	5.71"	145.0 mm	6326023	
	T-53EH Plus	7117170	.13 x .06 x .25	3.3 x 1.5 x 6.4	BULK	BULK	6543023	
	T-53EH Plus	6543005	.13 x .06 x .25	3.3 x 1.5 x 6.4	5.65"	143.5 mm	6543023	

\* Knight only recommends potential solutions for tubing applications. All chemicals should be tested in their proposed applications and under proposed conditions.

Peristaltic Squeeze  
**TUBES**  
Specification Sheet

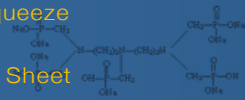

Squeeze Tubes are available in a wide variety of rubber and synthetic materials. Select the appropriate material that matches the flow rate of the pump and chemical to be pumped.

The chart below should be used as a reference tool only. Actual tube compatibility with chemical blends subject to environmental and "in situation" variables including:  
1.head pressure 2.temperature 3.viscosity 4.chemical concentration

	Model Number	Part Number	Dimensions (inch) ID X Wall x OD (ref)	Dimensions (mm) ID X Wall x OD (ref)	Length (inch)	Length (mm)	Roller Block	Description*
<p><b>F</b> FLURO VITON</p>	T-50F	7018186	.25 x .13 x .52	6.4 x 3.4 x 13.2	BULK	BULK	RB-550, RB-850	A Fluoro-Viton material designed to be compatible with Acids, Caustics, Hydrocarbons, Oils, natural Solvents, and Di-limonene.  Viton is a harder durometer tubing
	T-50F	7018086	.25 x .13 x .52	6.4 x 3.4 x 13.2	9"	228.6 mm	RB-550, RB-850	
	T-50F	7018089	.25 x .13 x .52	6.4 x 3.4 x 13.2	12.5"	317.5 mm	RB-550, RB-850	
	T-66-F	7018087	.35 x .13 x .62	8.9 x 3.4 x 15.7	12.5"	317.5 mm	RB-550, RB-850	
	T-75-F	7018188	.48 x .13 x .75	12.2 x 3.4 x 19.0	BULK	BULK	RB-975	
	T-75-F	7018088	.48 x .13 x .75	12.2 x 3.4 x 19.0	18.5"	469.9 mm	RB-975	
<p><b>M</b> MEDSIL</p>	T-50-M	7018000	.25 x .13 x .52	6.4 x 3.4 x 13.2	BULK	BULK	RB-550, RB-850	A commercial grade Silicone based tube good for Detergents, Alkalies, Chlorine, and mild Corrosives.  Not suitable for Solvents or Oils.
	T-50-M	7018001	.25 x .13 x .52	6.4 x 3.4 x 13.2	11"	279.4 mm	RB-550, RB-850	
	T-50-M	7018002	.25 x .13 x .52	6.4 x 3.4 x 13.2	14"	355.6 mm	RB-550, RB-850	
	T-53-M	7018005	.19 x .16 x .51	4.7 x 4.1 x 13.0	BULK	BULK	RB-553	
	T-66-M	7018010	.35 x .13 x .62	8.9 x 3.4 x 15.7	BULK	BULK	RB-550, RB-850	
	T-66-M	7018011	.35 x .13 x .62	8.9 x 3.4 x 15.7	14"	355.6 mm	RB-550, RB-850	
	T-86-M	7018015	.48 x .19 x .86	12.2 x 4.8 x 21.8	BULK	BULK	RB-986	
	T-86-M	7018016	.48 x .19 x .86	12.2 x 4.8 x 21.8	20"	508.0 mm	RB-986	
<p><b>S</b> SILICONE</p>	T-50-S	7018210	.25 x .13 x .52	6.4 x 3.4 x 13.2	BULK	BULK	RB-550, RB-850	A Silicone based tube good for Detergents, Alkalies, Chlorine, and mild Corrosives.  Not suitable for Solvents or Oils.
	T-50-S	7018211	.25 x .13 x .52	6.4 x 3.4 x 13.2	11"	279.4 mm	RB-550, RB-850	
	T-50-S	7018212	.25 x .13 x .52	6.4 x 3.4 x 13.2	14"	355.6 mm	RB-550, RB-850	
	T-66-S	7018213	.35 x .13 x .62	8.9 x 3.4 x 15.7	BULK	BULK	RB-550, RB-850	
	T-66-S	7018214	.35 x .13 x .62	8.9 x 3.4 x 15.7	14"	355.6 mm	RB-550, RB-850	
<p><b>T</b> THERMISTANT</p>	T-50-T	7018100	.25 x .13 x .52	6.4 x 3.4 x 13.2	BULK	BULK	RB-550, RB-850	The Santoprene based tube is generally resistant to strong to medium corrosive solutions including: Acids, Caustics, Chlorine, and Rinse agents.  Not suitable for Oils and Hydrocarbons
	T-50-T	7018101	.25 x .13 x .52	6.4 x 3.4 x 13.2	11"	279.4 mm	RB-550, RB-850	
	T-50-T	7018102	.25 x .13 x .52	6.4 x 3.4 x 13.2	14"	355.6 mm	RB-550, RB-850	
	T-53-T	7018097	.19 x .16 x .51	4.7 x 4.1 x 13.0	BULK	BULK	RB-553	
	T-53-T	7018096	.19 x .16 x .51	4.7 x 4.1 x 13.0	11"	279.4 mm	RB-553	
	T-66-T	7018106	.35 x .13 x .62	8.9 x 3.4 x 15.7	BULK	BULK	RB-550, RB-850	
	T-66-T	7018105	.35 x .13 x .62	8.9 x 3.4 x 15.7	14"	355.6 mm	RB-550, RB-850	
	T-86-T	7018107	.48 x .19 x .86	12.2 x 4.8 x 21.8	20"	508.0 mm	RB-986	

\* Knight only recommends potential solutions for tubing applications. All chemicals should be tested in their proposed applications and under proposed conditions.

# Anko Pumps

Commonly Found in Boumatic, Mueller  
and Delaval Installations

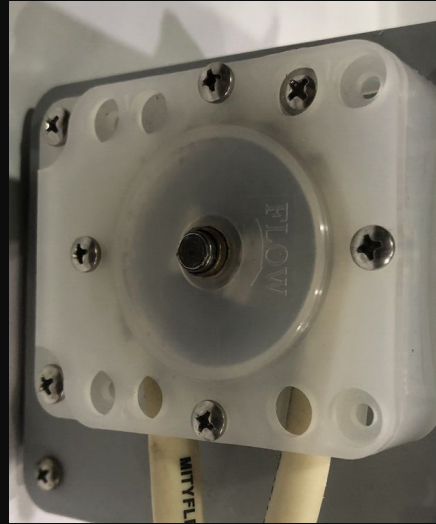

# Anko Pump Tubes

IBA#	Description	Notes
957625	SQUEEZE TBE F/SENTRY 2	pre-cut oem anko labeled tubing, will fit mueller and Delaval C125 pumps, will not fit Boumatic
957814	SANTO TUBING 1/4" WHITE	Santoprene tubing 7/16" X 1/4" by the foot
957815	25' SNTOPRNE TBE 1/4"X7/16"	Santoprene tubing 7/16" X 1/4" 25 feet
957816	25' VITON TBE 1/4X7/16	Viton Tubing 7/16" X 1/4" 25 feet

Flojet pumps



# FloJet Pumps and Spare Parts

IBA Code	Description	Material	Recommended use	<u>Not</u> Recommended for
906479	Flojet pump	Santoprene	Detergents, acids (except nitric), chlorine, Iodine	Nitric acids, Chlorine Dioxide, Footbath Chemicals
906478	Flojet pump	Viton	Detergents, acids, chlorine, Iodine (Better chemical resistance than Santoprene)	Chlorine Dioxide, Footbath Chemicals
906477	Flojet pump	Kalrez	Chlorine Dioxide Teat dips, Footbath Chemicals, harsh chemicals (better chemical resistance than Viton)	
906509	Flojet pump diaphragm kit	Santoprene		Nitric acids, Chlorine Dioxide, Footbath Chemicals
906510	Flojet pump diaphragm kit	Viton		Chlorine Dioxide, Footbath Chemicals



Dema

# Dema Pumps and Spare Parts

IBA#	Description	Notes
341220	IODINE BLENDING SYSTEM	3 pump system, one for water, one for iodine, one for emollient
341221	CIP DISPENSING SYSTEM	3 pump system for CIP dispensing
341222	ASC BLENDING SYSTEM	2 pump system for ASC (CL02) 2 part teat dip mixing (Pro-San, Pre-Sept, ect)
341223	MIXRITE PROPORTIONER	Water Driven Proportioning pump for injecting chemicals into water. Often used to setup sanitation for backflush.
957850	1/2" SQZE TBE W/MALE BARB	1/2" squeeze tube for smaller Dema pump
957851	5/8" SQZE TBE W/MALE BARB	5/8" squeeze tube for larger ("normal size") Dema pump